

ASSEMBLY INSTRUCTIONS

The Wyndham Arbor

New England
Arbors
Leadership by Design
www.newenglandarbors.com

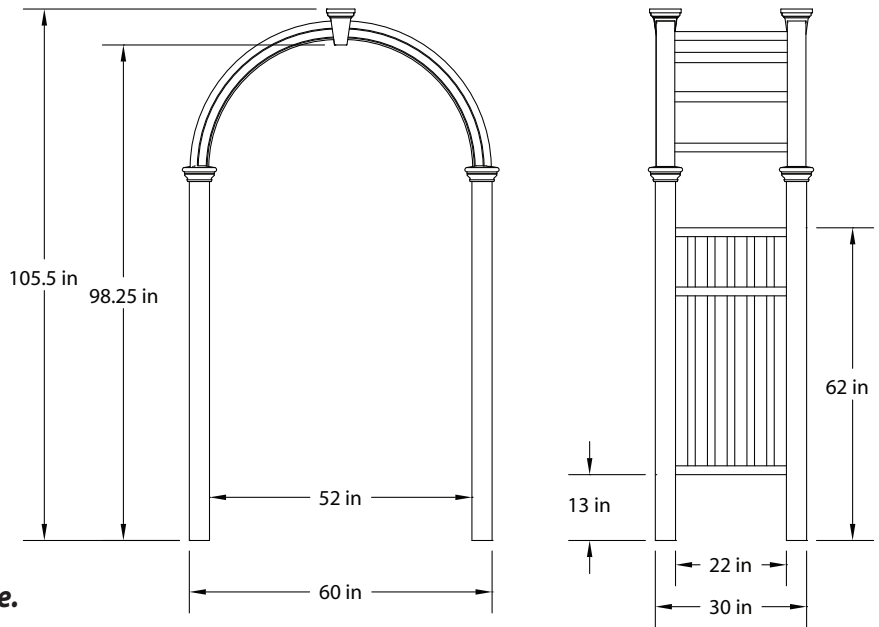
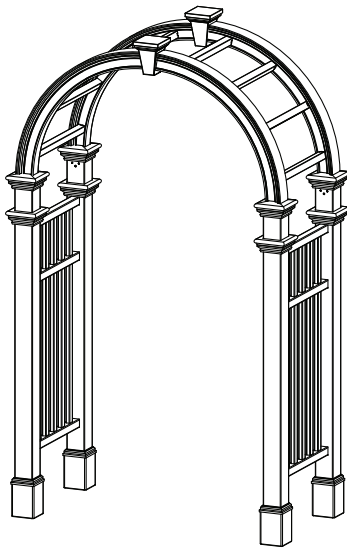

***Wyndham Arbor with Trim Kit Shown Above.**

Please read through before starting assembly.

IMPORTANT: CHECK THE INSIDE OF YOUR POSTS FOR ALL MATERIALS.

Check Box for These Contents

In the event of missing or defective parts please call our customer service dept. at **1 800 282 9346** (Mon. to Fri. 8:00 AM to 4:00 PM EST).

1. Keystone Top Lid (2)
2. Arch keystones (2)
3. Keystone Bottom Plate (2)
4. Arches (4)
5. Arch Rafter (8)
6. Post Caps (4)
7. Side Panel Top and Bottom Rails (4)
8. Side Panel Vertical Spindles (10)
9. Side Panel Middle Rails (2)
10. Posts (4)
11. #8 x 2 1/2 in. (6.4 cm.) Stainless Steel Screws (For Keystone and Arch to Post Connection) (16)

If you purchased the arbor along with our decorative trim kit, there will be a separate box with the following contents;

12. Post Trim Caps (4)
13. Base Molds (4)

Tools You Will Need

- Cordless Drill
- Hammer
- Tape Measure
- Level
- Stool or Short Ladder
- Shovel or Auger

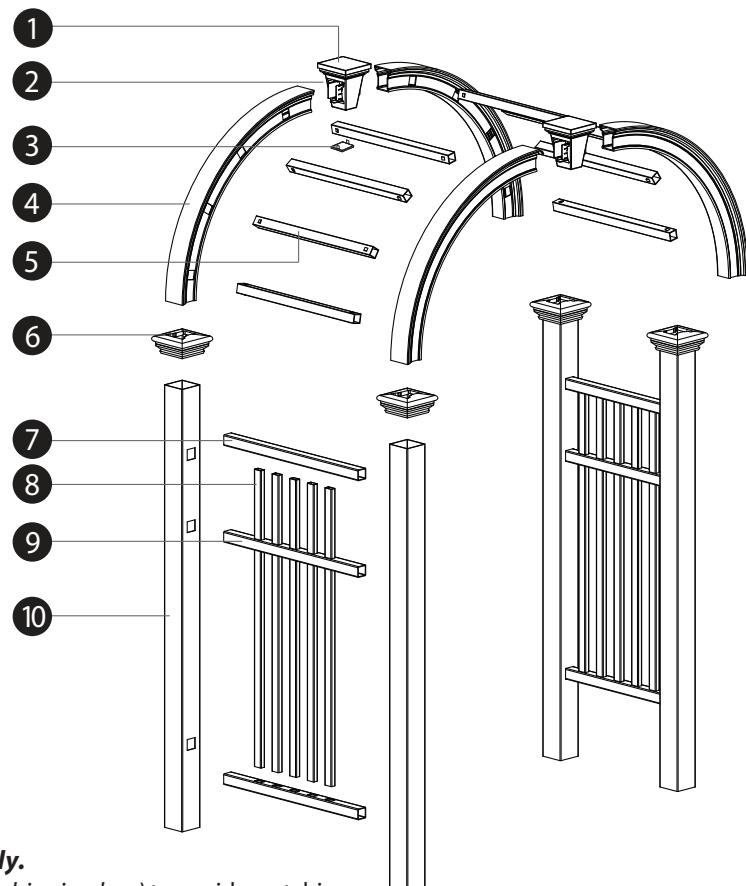
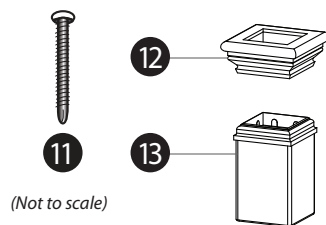

General Information

- **Read Instructions through carefully before beginning assembly.**
- When assembling components, place on a non-abrasive surface (i.e. shipping box) to avoid scratching.
- We recommend an area approx 10'x 8' for unobstructed assembling.
- You should not need to use excessive force when assembling components.

STEP ONE

Assemble the Arch System

NOTE: There are locking tabs located at the ends of each rafter. Once inserted and pushed into the routed holes, they will lock into place and cannot be removed.

- 1 Insert arches into arch keystone ensuring they terminate flush to the internal connector.
- 2 Fasten the top of the arches to the keystone insert by installing 2 1/2 in. (6.4 cm.) screws into the two flanges on either side of the top of the insert.
- 3 Invert the arch system and install two screws 2 1/2 in. (6.4 cm.) from the bottom of the keystone into the two flanges on either side of the bottom of the insert. This will connect the bottom of the arches to the insert.
- 4 Seal the bottom hole on keystone by inserting the bottom plate as provided.
- 5 Install the top cap on the arch keystone. Ensure keystone cap is pushed down firmly so the cap locks into position.
- 6 Repeat for other arch.
- 7 Insert arch rafters (8) into the holes on the arches until they bottom out inside the arches. There are "locking tabs" located at each end of these rafters that once inserted into the holes will lock into place.
- 8 Fit opposite arch system over rafters.

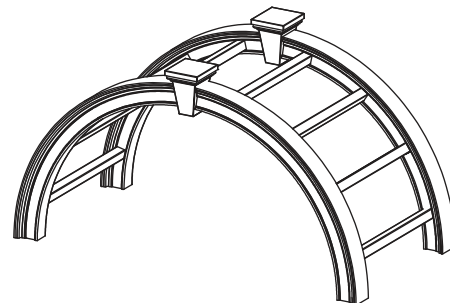
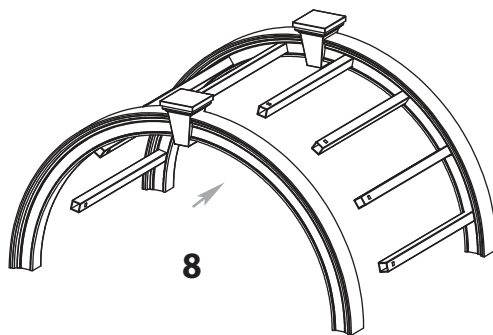
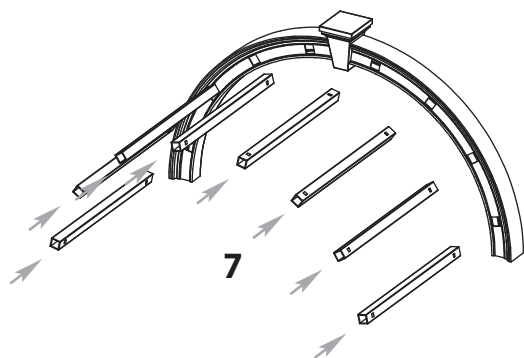
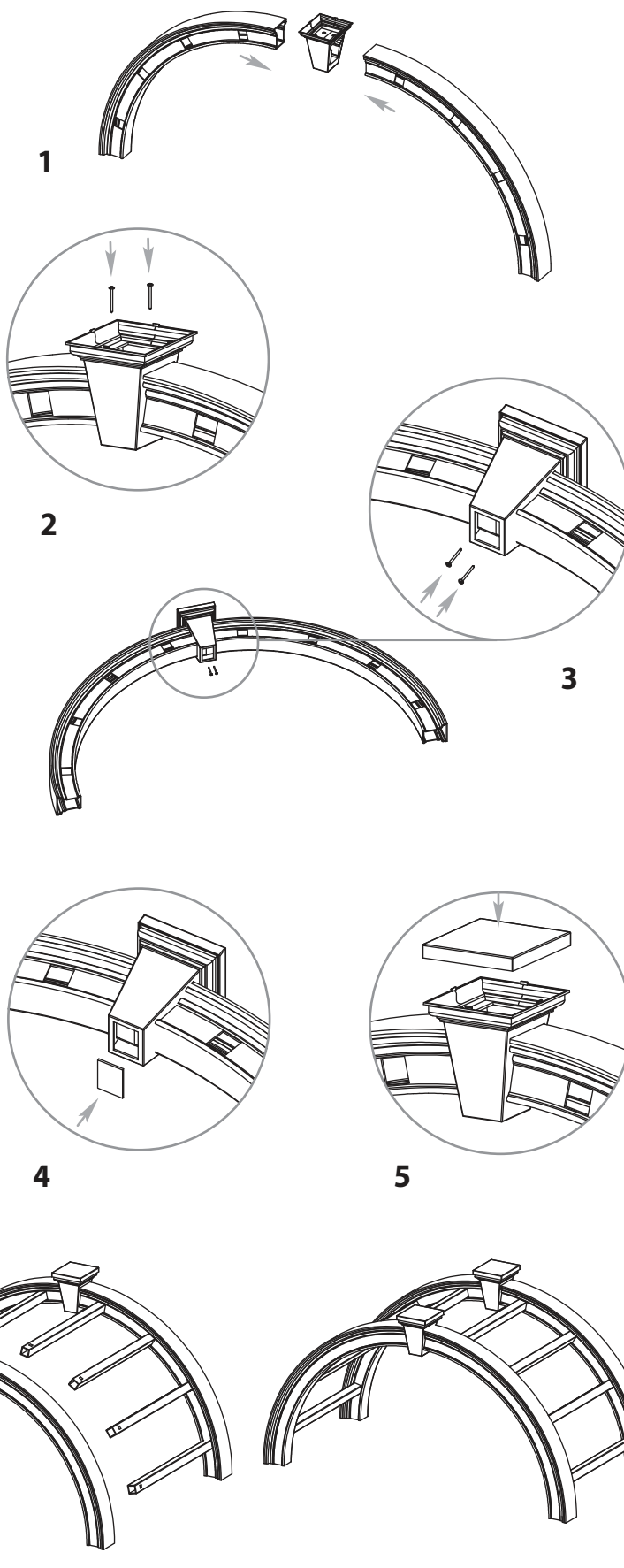

STEP TWO

Assemble the Side Panels

- 1** Insert the vertical spindles into the middle horizontal rail (holes on both sides) followed by the top and bottom rails as shown.
- 2** Lay one of the post down with the holes facing up and Insert the sub-assembly from the step above into the routed holes as shown.
- 3** Align and insert a second post onto each of the rails.
- 4** If you purchased the extra Trim Kit, slide the second set of post trim cap over the top of each post as well as the base trim to the bottom of each post as shown.
- 5** Repeat for second side panel.

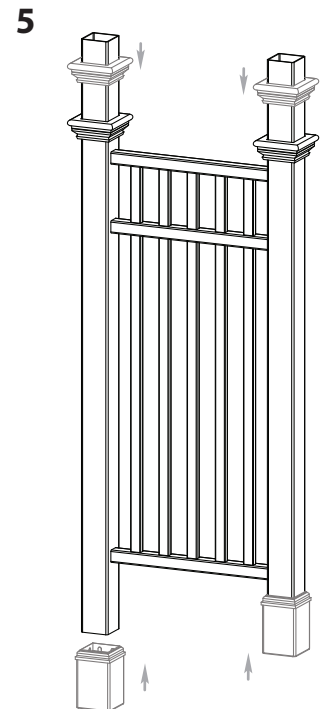
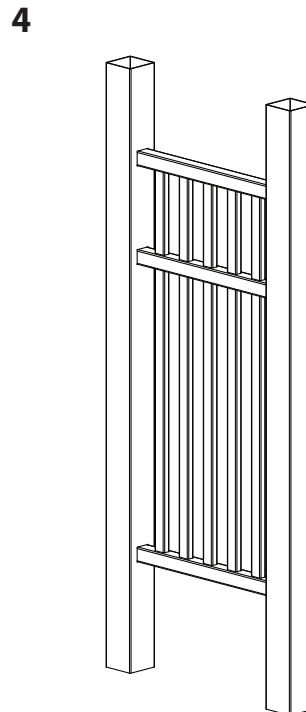
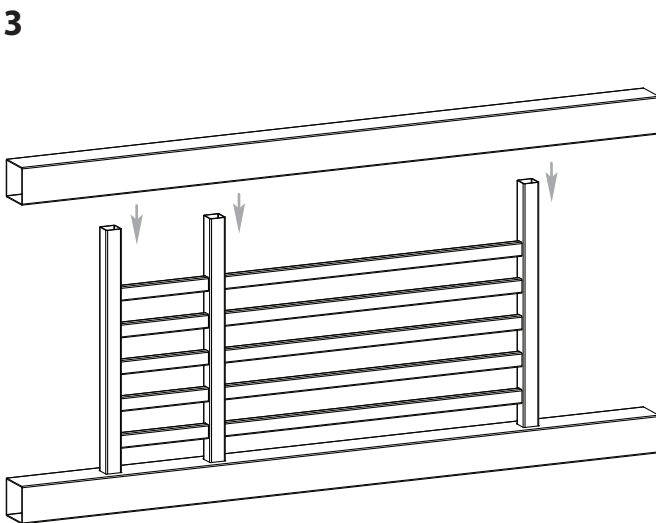
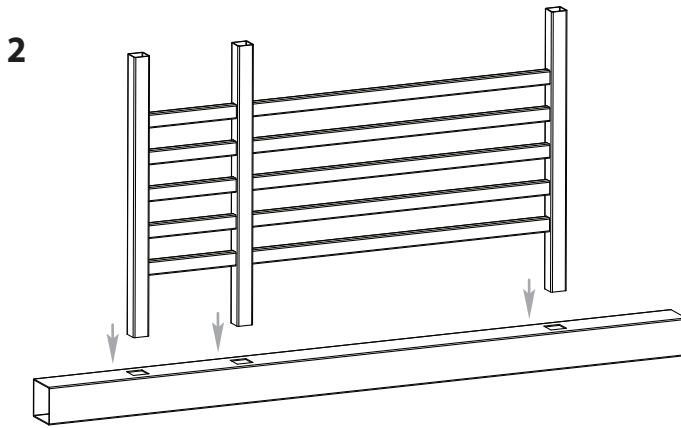
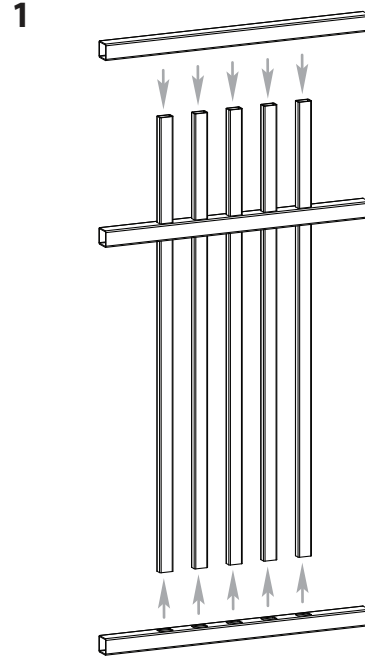

STEP THREE

Install the Side Panels.

You have Three Options to Complete this Step.

(All Purchased Separately)

OPTION ONE - If Your Arbor:

- is going to be installed with fencing or a gate
- is located in a high wind or hurricane area
- is located in ground conditions that are not level

Consider Using:

A - 4x4 Professional Post Extension Kit (30 in./76.2 cm. long), (Kit of 4)

- Purchase from New England Arbors, www.newenglandarbors.com
- Recommended to be installed in concrete footings
- Follow instructions included with the kit

- or -

B - 4 x 4 x 8 Long Wood Posts (2)

- Purchase separate from your local lumberyard
- Recommended to be installed in concrete footing
- Cut Each Wood Post in half and use each half in the bottom of the four posts.

OPTION TWO - If Your Arbor:

- is intended to be used as a stand alone garden accent or pathway
- is located on level ground

Consider Using:

4 x 4 Aussie Augers (Kit of 4)

- Purchase from New England Arbors, www.newenglandarbors.com
- Instructions are included with the kit

OPTION THREE - If Your Arbor:

- is going to be installed onto pre-existing concrete or wood surface

Consider Using:

4 x 4 Surface Mount Kit

- Purchase from New England Arbors, www.newenglandarbors.com
- Follow instructions included with the kit

Into Earth with Concrete Footing (Option One)

(Assuming posts have been extended)

Arbors must be well secured to prevent tipping over from wind load, etc.

- 1** Move the side panels to their final location (*you will need a helper*).
- 2** When you have identified the location of each post, as indicated by the measurements on the first page of these instructions, mark the positions of the posts, then move the panels aside.
- 3** Excavate four holes approx 33 in. (83.8 cm.) deep. The location and excavation of these four holes is the most critical step and should be completed with care. The depth of these holes will allow the post extension (if chosen as option) joint to be hidden 3 in. (7.6 cm.) under the ground.
- 4** Carefully move the side panels back into position and level both horizontal and vertically.
- 5** Check your measurements to confirm posts are placed correctly to receive arch system. **THIS IS A CRITICAL STEP.**
* **Do not backfill the holes with cement at this stage.**

1

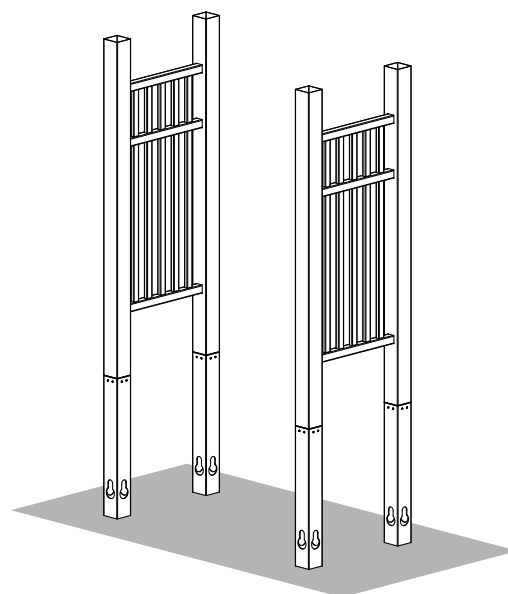

(Posts have been extended with 4x4 Professional Post Extension Kit)

2

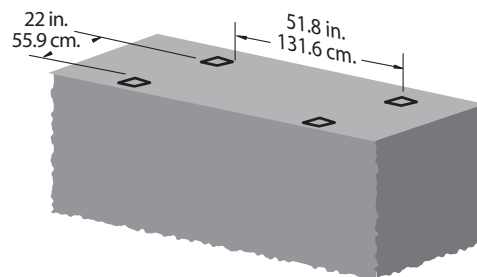

(Measurements shown are inside to inside of posts)

3

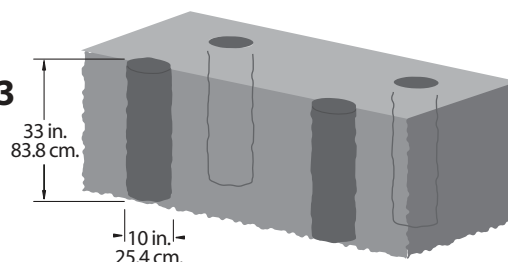

4

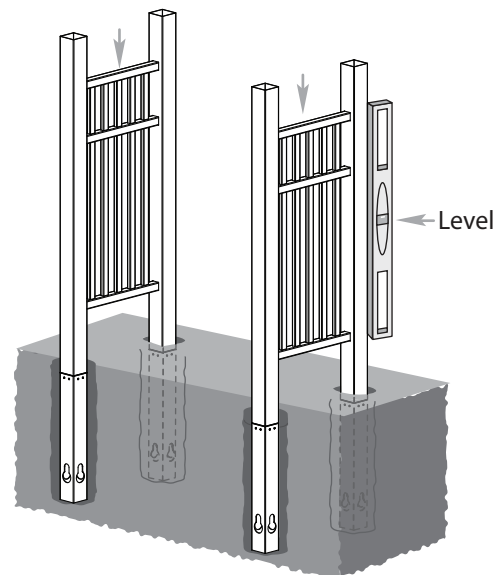

STEP FOUR

Connect the Arch System to the Side Panels

- 1** Temporarily position post caps on bottoms of arches.
- 2** With a helper, slide down the arches until the bottom of the spoke is approximately 1" above the post cap.
- 3** Slide post caps down into position.
- 4** Install long screws into the posts and through the arches.

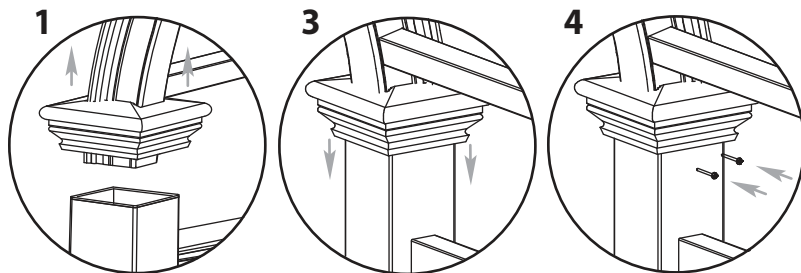

STEP FIVE

Fill Excavated Holes

- 1** Ensure that posts and side panels are level.
- 2** Fill around the posts with wet cement within 3 in. (7.6 cm.) of your natural elevation.
- 3** Complete a final level check both horizontally and vertically, and backfill the remaining space between concrete and natural elevation with topsoil.

