

SHOWER

IT-590044

ASSEMBLY INSTRUCTIONS

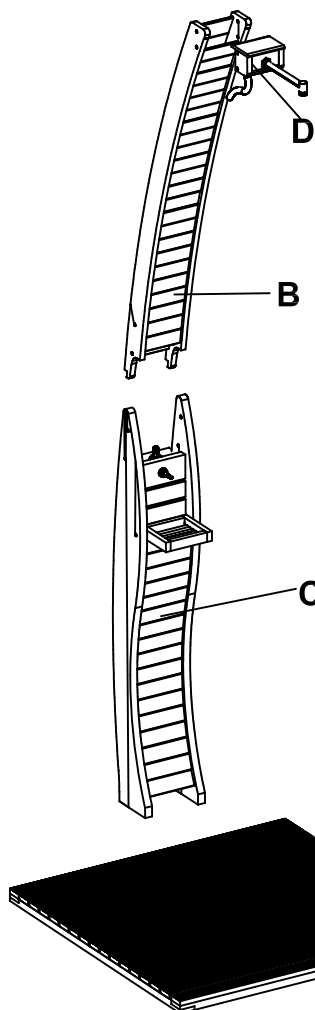

LIST OF WOODEN PARTS

NO.	DESCRIPTION	Q'TY
A	BASE FRAME	1 PC
B	UPPER FRAME	1 PC
C	BOTTOM FRAME	1 PC
D	SHOWER HOLDER	1 PC

QUESTION ?

Identify all parts and hardware. If any pieces are missing call our toll free number at 1-888-287-4275 from 9:00 am to 5:00 pm CST (Monday to Friday) for replacement parts. For faster service, have the style number handy when calling.

LIST OF HARDWARE PARTS :

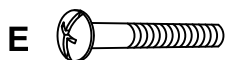

1 1/2" BOLT 4 PCS + 1

H



KNOB HEAD 1 PC



1" BOLT 8 PCS + 1

I



SHOWER HEAD 1 PC

G



HOSE CLAMP 2 PCS

J



WOODEN CAP 6 Pcs + 1

TOOLS REQUIRED :

FOR PROPER ASSEMBLY USE THESE TOOLS.

1. PHILLIPS SCREWDRIVER (NOT INCLUDED)
- FOR TIGHTENING ALL BOLTS & SCREWS.
2. PHILLIPS FLAT SCREWDRIVER (NOT INCLUDED)
- FOR TIGHTENING HOSE CLAMP.
3. ALLEN WRENCH (INCLUDED)
- FOR TIGHTENING THE KNOB HEAD.

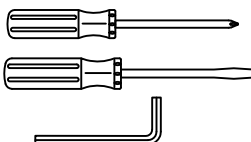

* ASSEMBLE YOUR UNIT IN AN AREA FREE FROM ANY OBJECTS THAT MIGHT SCRATCH THE SURFACE OF YOUR UNIT.
* EXAMINE ALL PACKING MATERIAL BEFORE DISCARDING, SHORTAGES MAY OCCUR FROM PARTS LEFT IN THE PACKING MATERIAL.
* PLEASE READ THE INSTRUCTIONS CAREFULLY, AND VERIFY ALL PARTS ARE INCLUDED.
* ALL BOLTS AND SCREWS ARE NEED TO BE TIGHTENED FROM TIME TO TIME TO AVOID DAMAGE.
* NEED AT LEAST TWO PERSONS TO ASSEMBLE THIS SHOWER.

ASSEMBLY INSTRUCTIONS

1

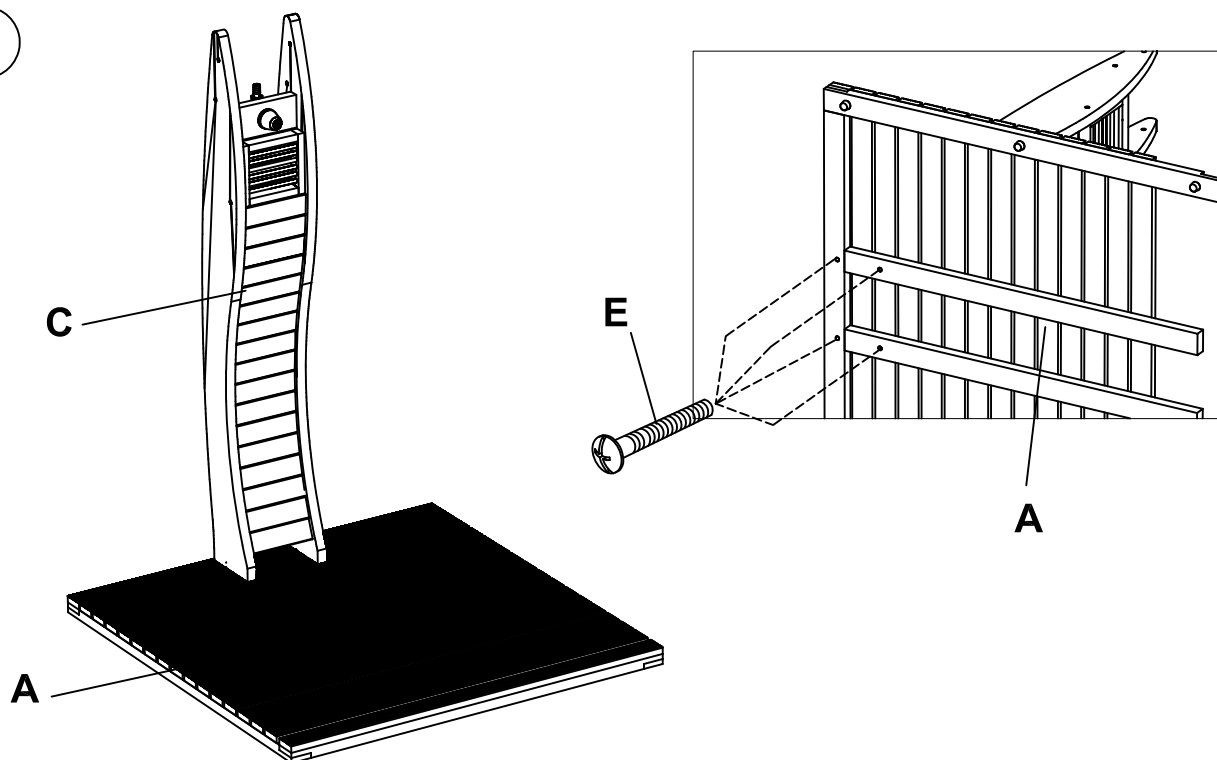

- ATTACH THE BOTTOM FRAME (C) INTO BASE FRAME (A) AND SECURE FROM BENEATH OF BASE USING 1 1/2" BOLTS (E) AS DIAGRAM SHOWN.
- TIGHTEN ALL BOLTS USING PHILLIPS SCREWDRIVER.
- UPRIGHT THE PRE-ASSEMBLED BOTTOM FRAME.

2

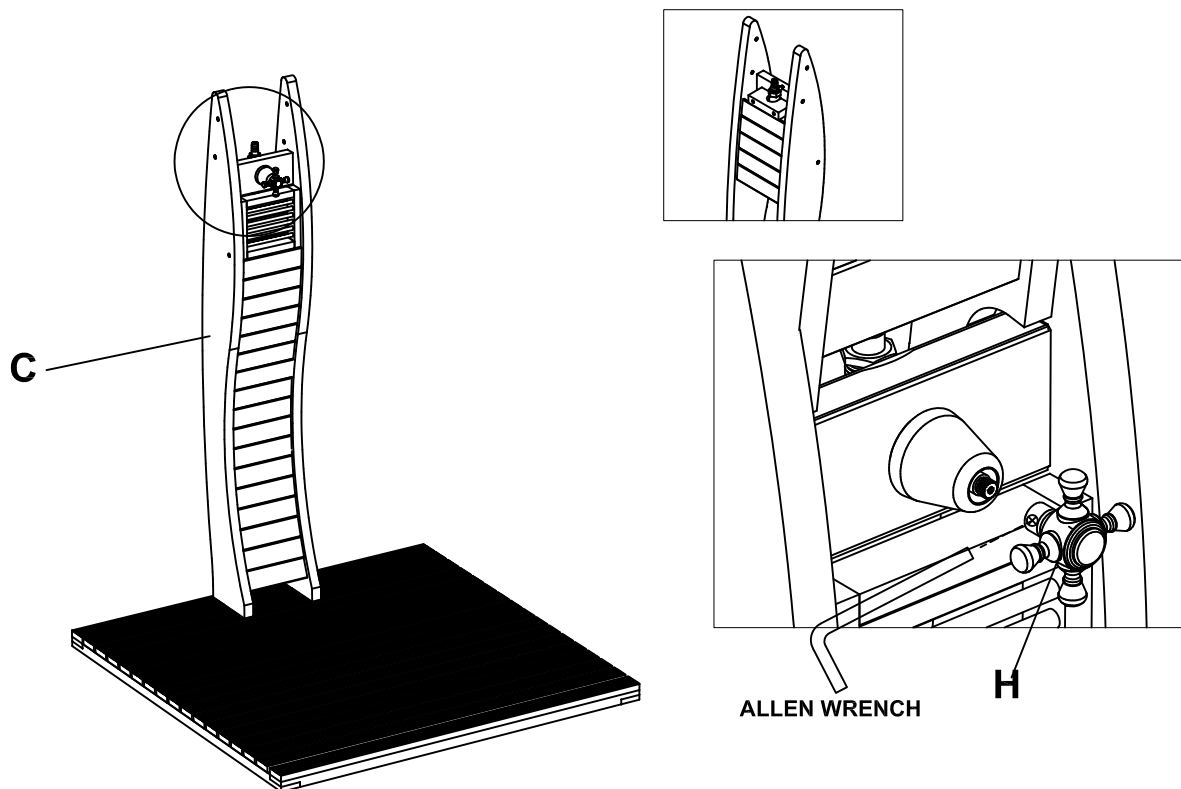

- ATTACH THE KNOB HEAD (H) INTO KNOB OF UPPER FRAME (C) AND TIGHTEN THE HEAD KNOB USING ALLEN WRENCH.

3

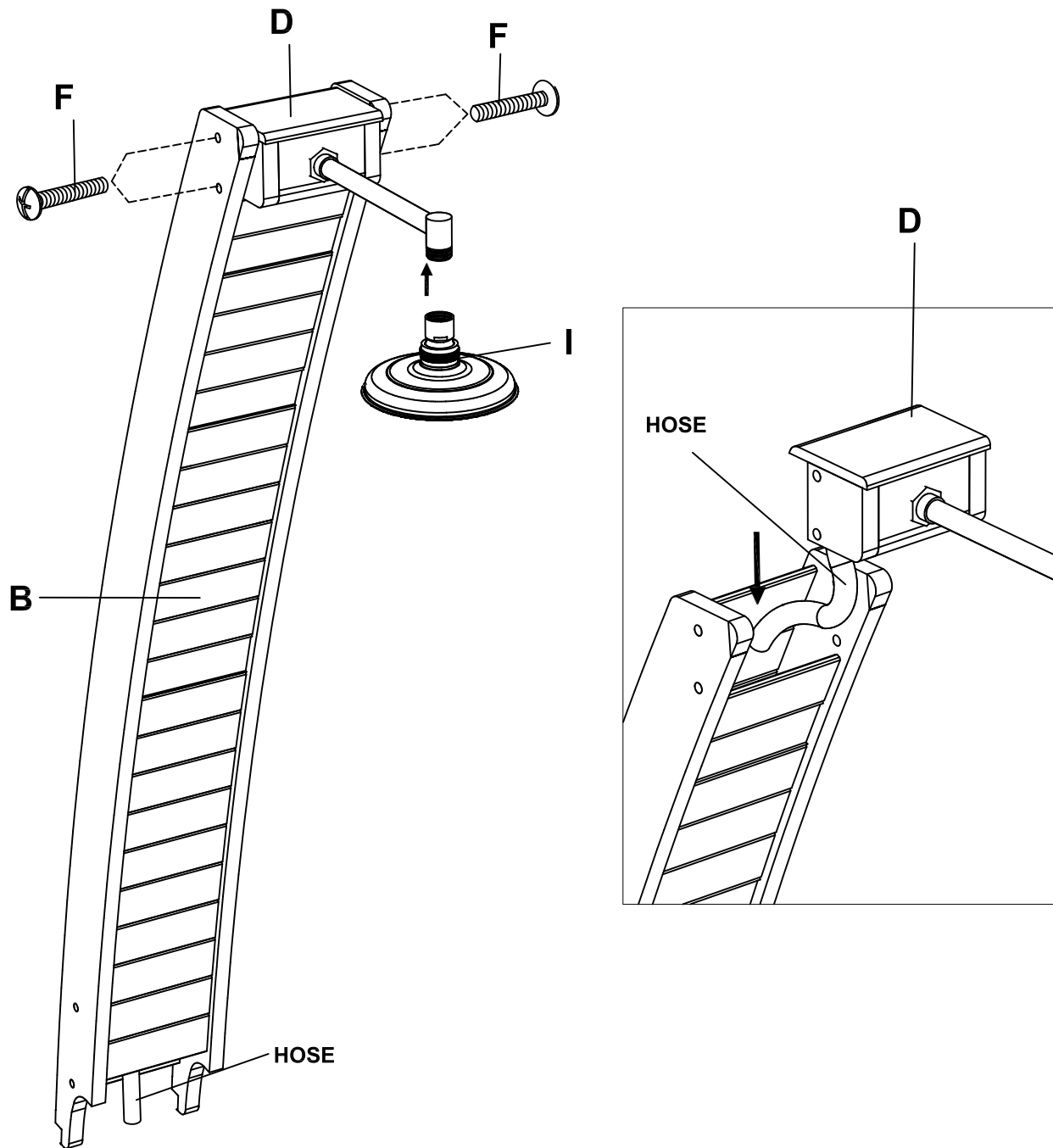

- INSTALL THE HOSE SHOWER HOLDER (D) INTO CONNECTOR AND SECURE THE HOSE USING HOSE CLAMP. MAKE SURE IT IS TIGHT USING FLAT SCREWDRIVER. AND THEN SECURE SHOWER HOLDER (D) USING 1" BOLTS (F).

NOTE :

YOU HAVE TO ADJUST TO PLACE THE CURVED PIPE IN A 90° POSITION WITH THE SHOWER HEAD POINTING STRAIGHT DOWN.

- ATTACH THE SHOWER HEAD (I) INTO CURVED PIPE.

4

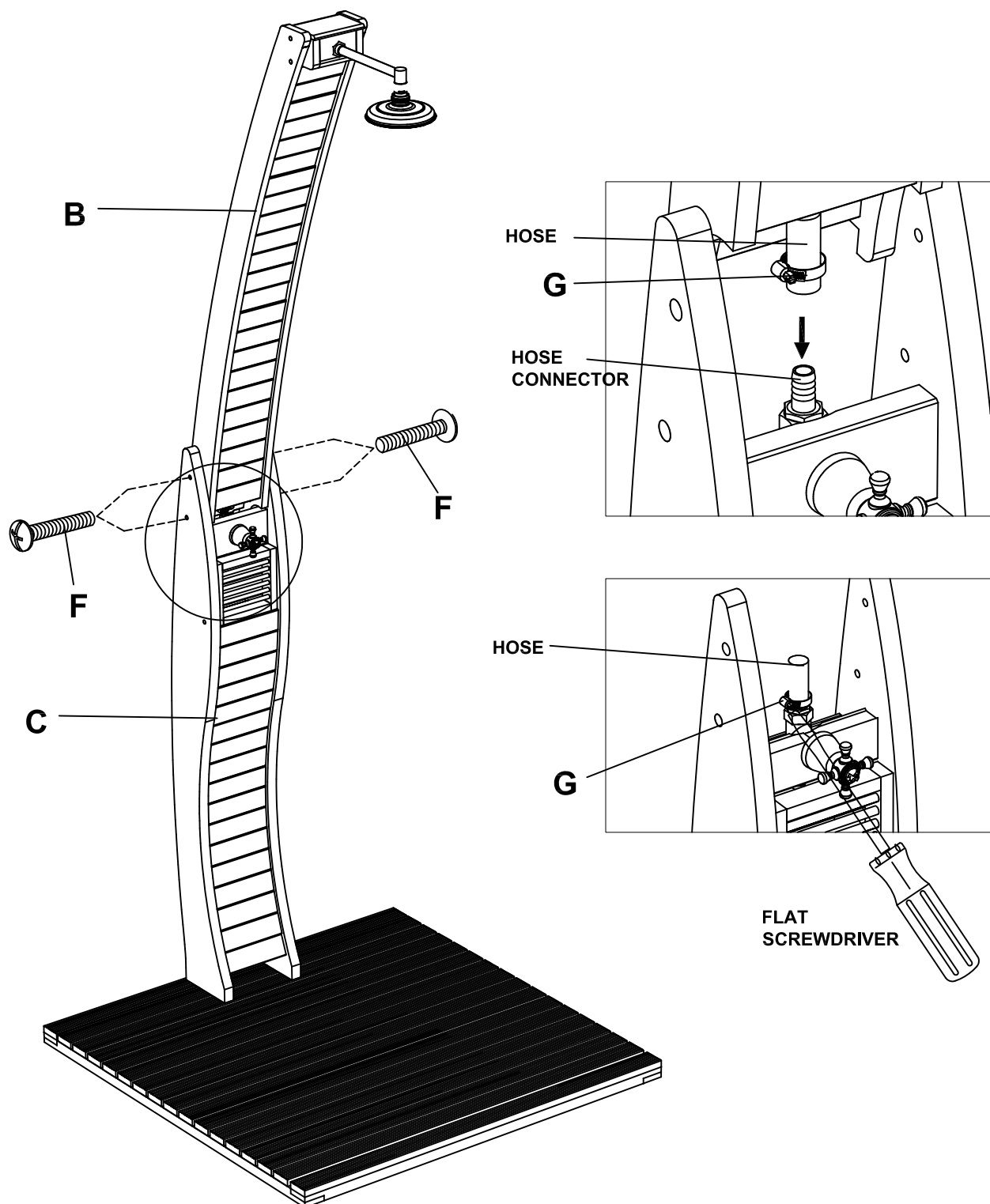

- BEFORE ATTACH THE UPPER FRAME (B), INSTALL THE HOSE OF UPPER FRAME (B) STRAIGHT DOWN TO PRE-ASSEMBLED OF HOSE CONNECTOR.
NEXT, TIGHTEN THE HOSE USING STAINLESS CLAMP (G) COMPLETELY USING FLAT SCREWDRIVER.
** MAKE SURE THE HOSE IS TIGHT TO AVOID DAMAGED BY LEAKAGE.
- NEXT, SECURE THE UPPER FRAME (B) INTO BOTTOM FRAME (C) USING 1" BOLTS (F), POSITION AS SHOWN.

5

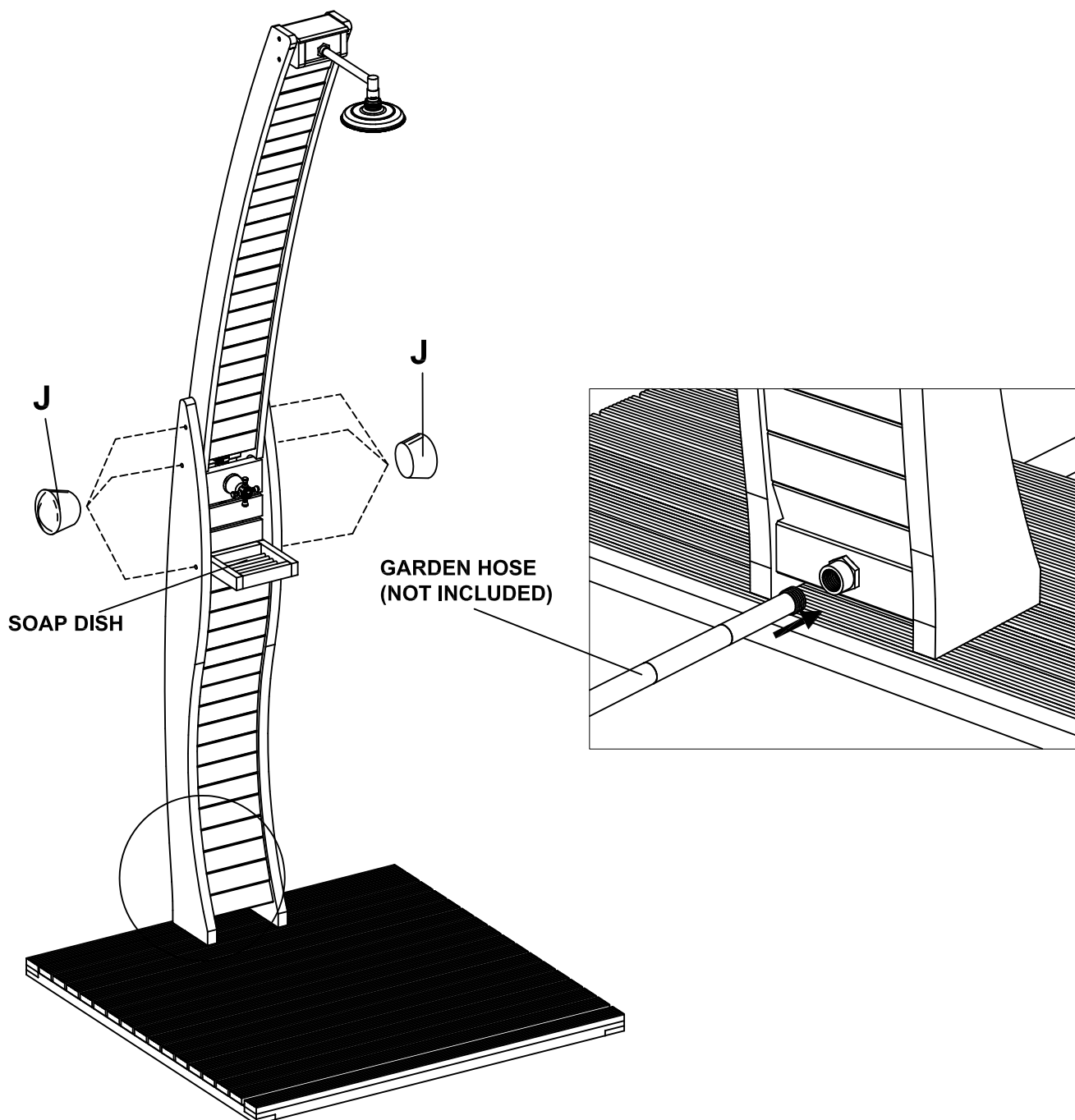

- MAKE SURE ALL PARTS ARE CORRECTLY CONNECTED AND TIGHTEN ALL BOLTS COMPLETELY BEFORE TAPPING IN THE WOODEN CAPS (J) USING RUBBER Mallet.
- UNFOLD THE PRE-ASSEMBLED OF SOAP DISH.
- INSTALL THE GARDEN HOSE INTO CONNECTOR OF BOTTOM LOWER FRAMES AS SHOWN.

CONGRATULATIONS !
THE SHOWER IS NOW READY TO USE.